

Dimensional Drawing

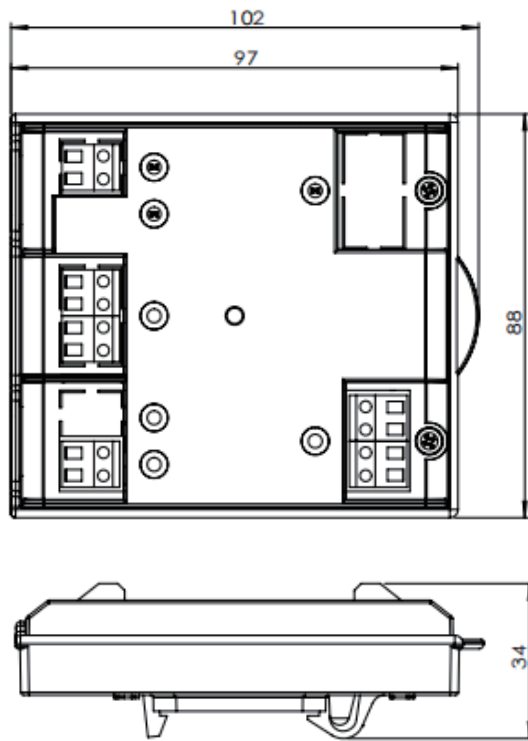

Status Indications

| Legend | LED Status | Description |
|---------------|----------------|-------------------|
| Output Active | Continuous Red | Output active LED |
| Input Active | Continuous Red | Input active LED |
| Polling | Flashing Red | Polling LED |

Electrical Consideration

The quiescent current of Input/Output Module is 2mA at rated voltage of 24V DC.

Mechanical Construction

The main components of the Input/Output Module are molded in a robust fire-retardant polycarbonate and PC/ABS.

The Input/Output Module is designed to be mounted on a 35mm width DIN-Rail inside an enclosure.

NOTE: This unit is not designed for outdoor use.

Operating Modes-Input Modes

| Mode | Description |
|------|--|
| 1 | Input circuit fault is reported when the input line is short circuit (Default) |
| 2 | The input activation is reported when the input line is short circuit |

Operating Modes-Input Delay Modes

| Mode | Description |
|------|---|
| 1 | 0S delay after input activation (Default) |
| 2 | 10S delay after input activation |
| 3 | 20S delay after input activation |
| 4 | 30S delay after input activation |

Operating Modes-Output Operating Modes

| Mode | Description |
|------|---|
| 1 | Continuous output after output activation (Default) |
| 2 | Pulse output after output activation (1S Open 1S Close) |
| 3 | Pulse output after output activation (3S Open 1S Close) |
| 4 | Pulse output after output activation (6S Open 1S Close) |